



PROVOKE

PROVOKE

As an architectural firm relocating our office, we had the opportunity to design a new work space that has re-energized the spirits of the architects and designers and fosters cross-studio dialogue. Our 140-person office allows us to practice as a think-thank, promoting collaboration and inspiring innovation through direct human interaction. We are organized into three design studios of 20-40 architects, each led by three or four partners. This combines the intimacy of a small practice with the extensive resources of a major design firm.

DESIGN PROBLEM

After two years of occupancy we learned the platform, a space originally designated as a collaboration zone and located on the north side of the office overlooking the Fort Point Channel, does not yet serve its intended purpose. An office wide Post Occupancy Evaluation fostered further evidence of a real life design problem, to which many users offered similar solutions — provide a breakout space with soft seating to create a casual and comfortable environment. At present, the remainder of the floor plan lacks areas providing a variety of furniture types inviting for individuals or small groups to break away from their desks, collaborate or socialize in a comfortable, informal setting. The platform area has been identified as an area that is under-utilized and uninviting for casual use, yet ripe and awaiting opportunity.

DESIGN SOLUTION

In keeping with the new, wide-open space that functions as a laboratory and workshop, we propose a design evoking a living room with a variety of flexible furniture pieces that motivate, invite and foster new collaborative relationships throughout the firm. As a firm with design and innovation at the forefront of our practice, we understand that creativity flourishes with the right support and the right environment. The cozy spaces created in the *Provoke* design encourage staff from all over the office to relax and collaborate in the new firm living room. By sub-dividing the space into intimate areas, several groups can converge in this location. The *Mindshare* area invites relaxed working meetings while the whiteboard area encourages brainstorm, and the *Hedge* offers a place to stand or sit while taking advantage of the view.

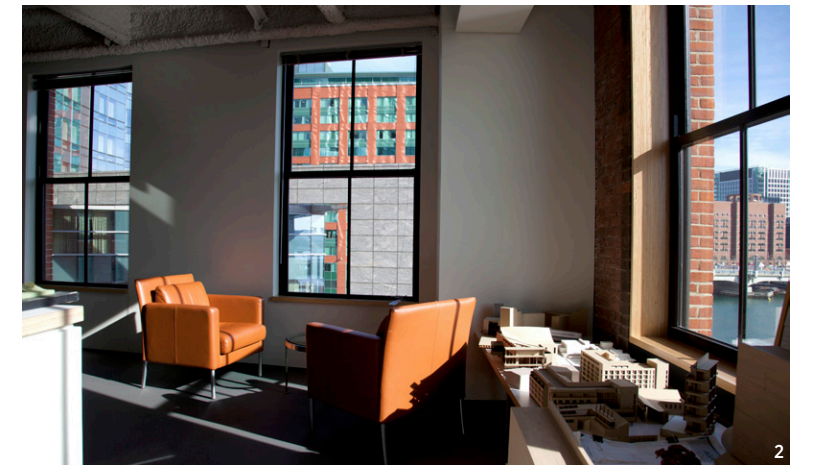
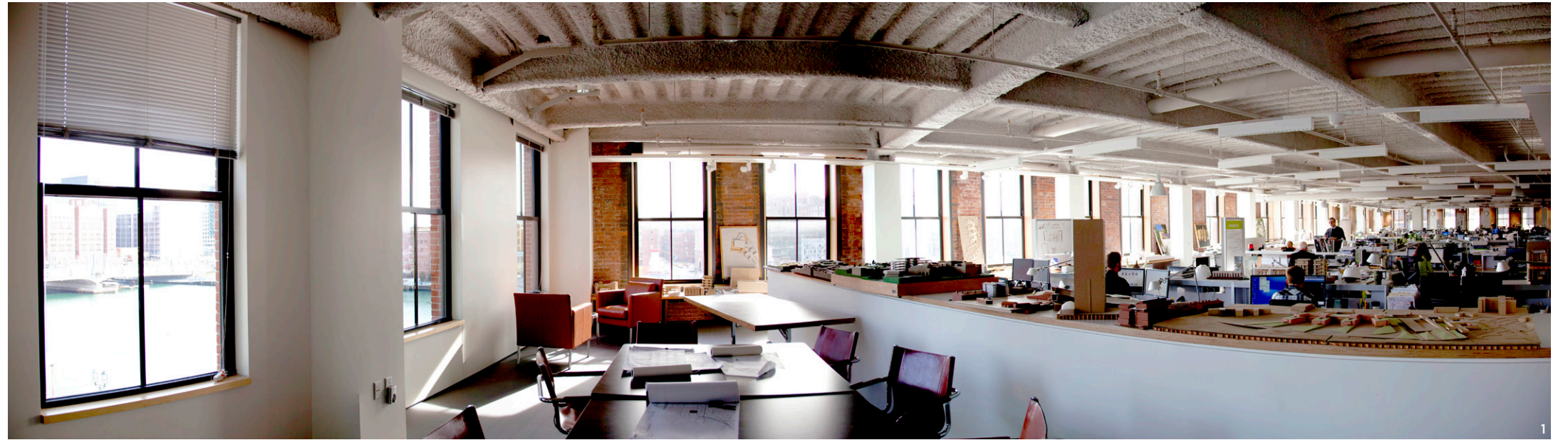

Clockwise from top

1 Platform Panoramic

2 Platform Photograph

3 Platform Photograph

4 View from the Platform

PROVOKE

We at Payette care about providing an environment that fosters creativity and design. Throughout this submission you will notice quotes referencing the re-purposing of the platform area. These quotes are from our office wide Post-Occupancy Evaluation which serve as the foundation of our inspiration to use the Allsteel products to Provoke, to Invite and to Activate.

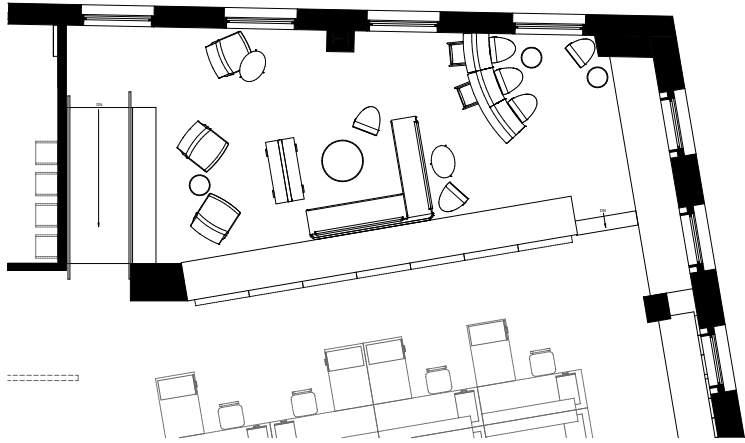

- 1 The Linger chair and Transfer table offer the perfect place to escape for a moment.
- 2 The combination of the Hedge and Scooch encourage staff to have a casual lunch and discussion while taking in the best view in the house. The Hedge also provides relief from sitting at one's desk all day and an opportunity to "think on your feet."
- 3 The Mindshare and View combination offer a place to collectively view images and prep for presentations in an informal setting.
- 4 The Linger chairs offers a comfortable space to look at periodicals and new books from our Library. The added bonus of the View allows a place for informal brainstorming.

“The formality of all the workstations needs to be offset with clusters of **flexible soft seating**.”



“The office could use a **comfortable and informal lounge** for break-out discussions or having lunch.”



1

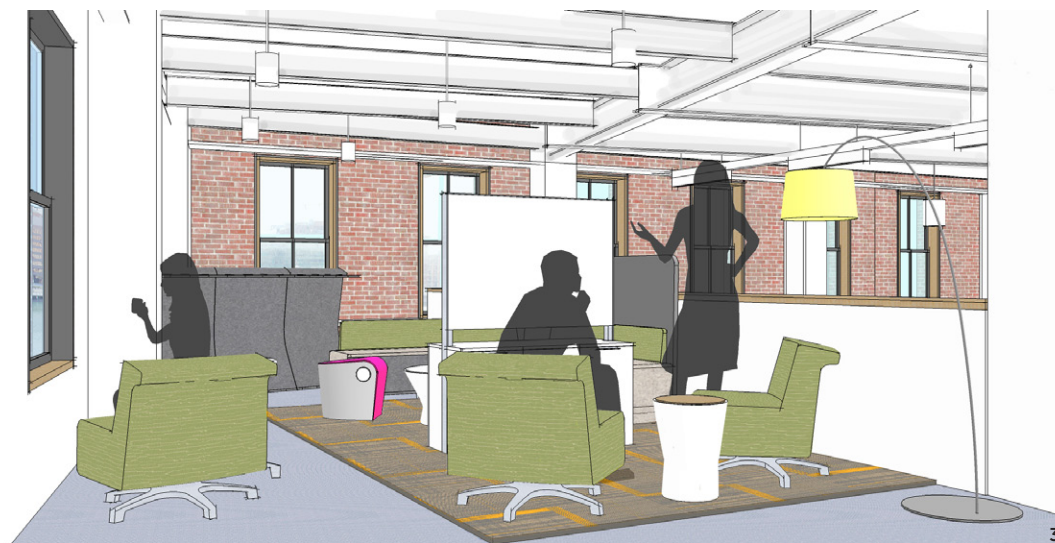

3

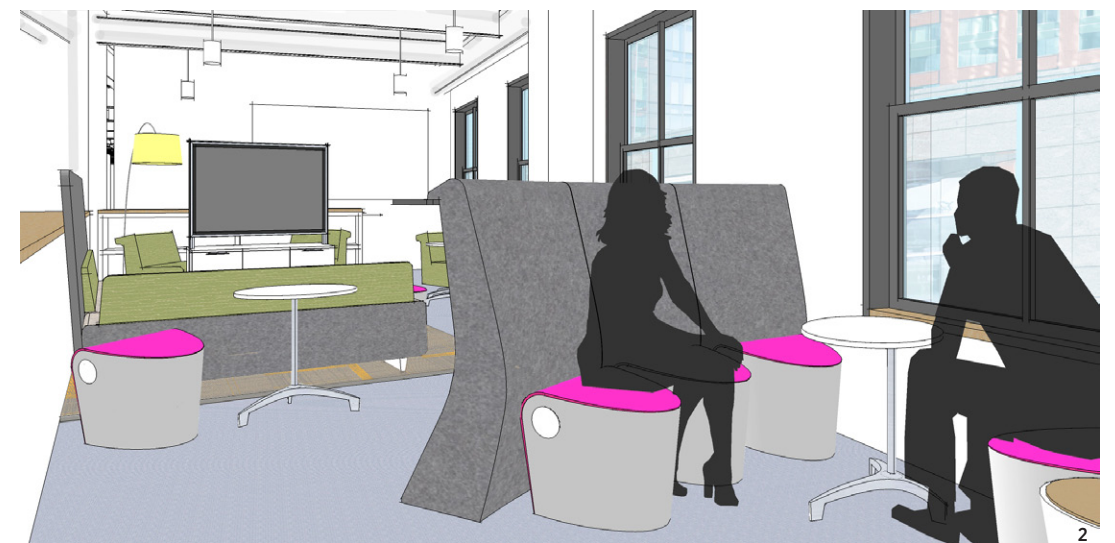

2

1 The Mindshare cluster creates a “living room setting” while the functionality of the View provides an opportunity to review presentations and graphics in an informal setting.

2 The Hedge and Scooch combination will allow staff a space to breakout for informal gatherings and lunch meetings while benefiting from the beautiful view.

3 The Linger clusters allow a space to escape and read periodicals or catch up with the new books from the Library, all with the added bonus of the integrated whiteboard in the View, which is perfect for capturing that “Ah-ha” moment.

PROVOKE — MATERIALS PALETTE

“The space would benefit from **carpeting** and **upholstery** to absorb the acoustics.”



The materials palette for this scheme maintains a dialogue with the existing materials, yet offers an opportunity to be playful and punchy with new colors. Additionally, the upholstered furniture and carpeting will help dampen the acoustic properties of the space.